



Capital Program Update

Lynnfield Center Water District
Building a More Resilient Water Supply

Mike Nelson
Anne Malenfant
Al LeBlanc

December 16, 2021



**CDM
Smith**[®]

Capital Program Projects

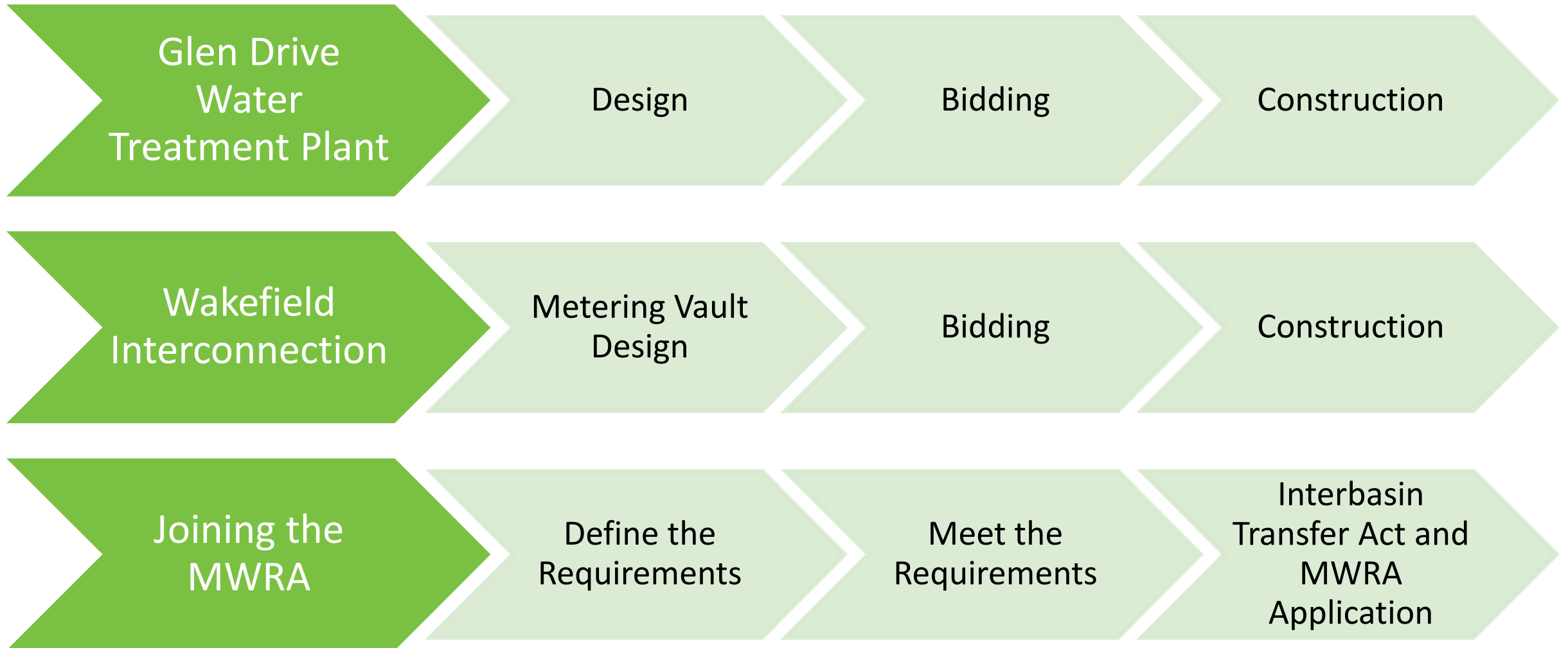

Capital Program Projects

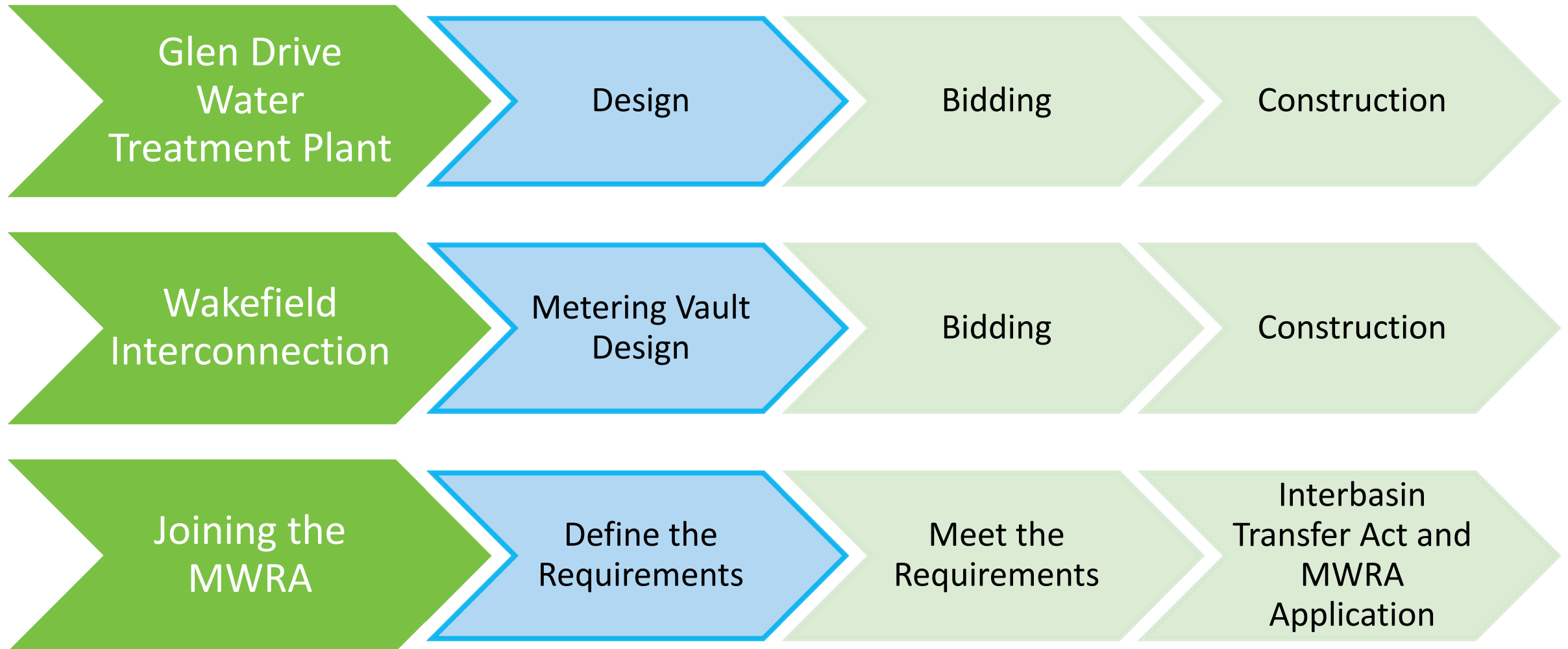

Glen Drive Water Treatment Plant Design

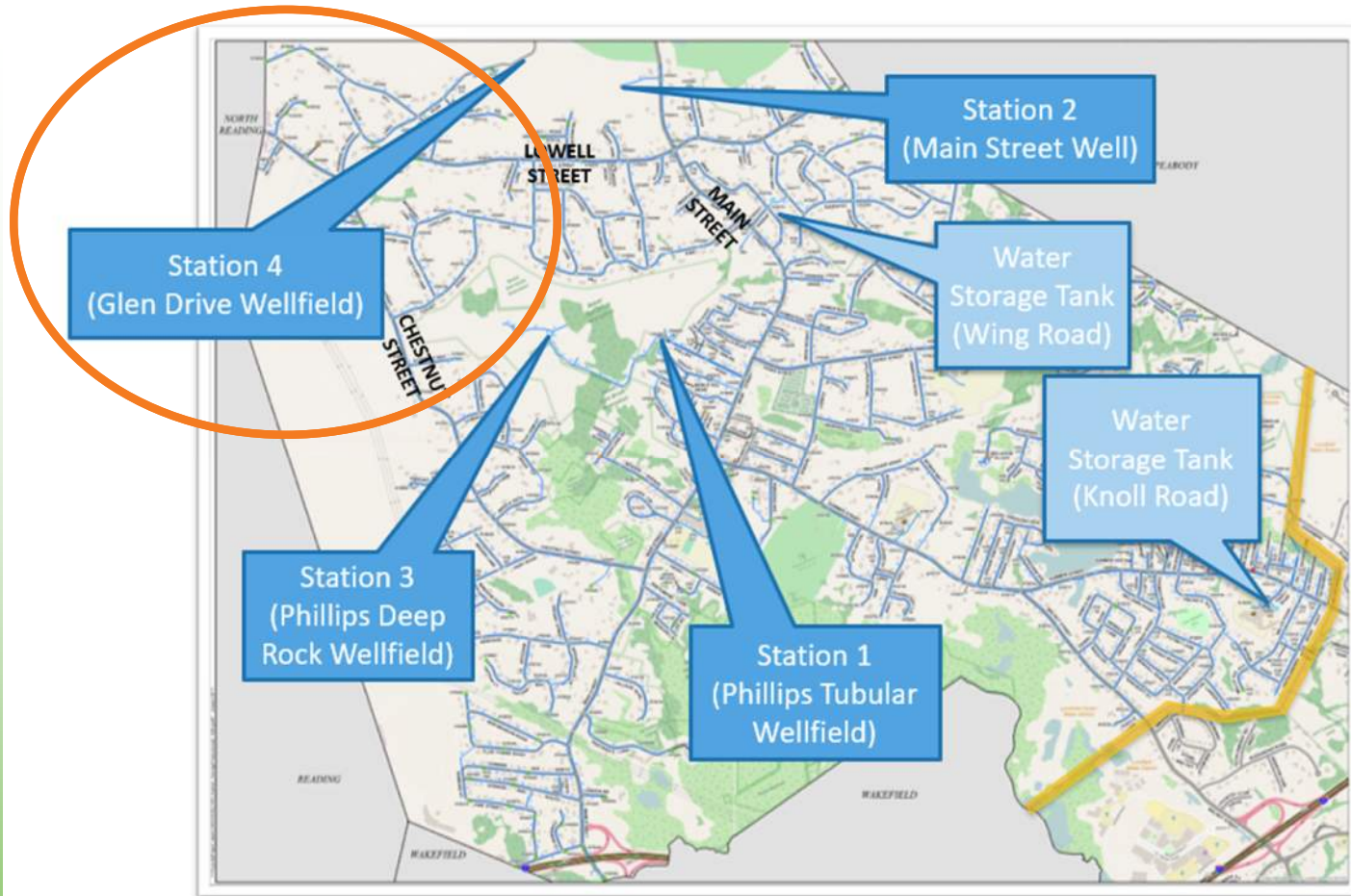

Glen Drive Water Treatment Plant Design

- Existing Glen Drive Pump Station
- Addition of greensand filters to remove iron and manganese

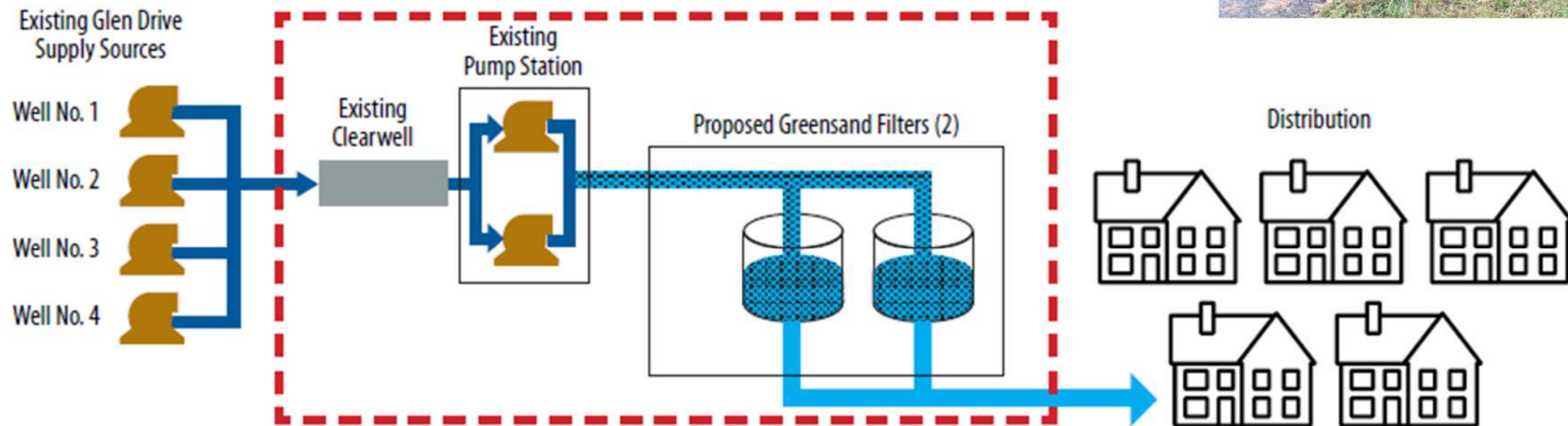

Glen Drive WTP Design - Piloting

- Pilot Plan submitted to MassDEP
- Responded to comments from MassDEP
- Site visit for planning/coordination with Blueleaf (subcontractor)
- Awaiting approval of Pilot Plan from MassDEP
- January 2021 start for piloting



Glen Drive WTP Design – Survey and Borings

- Flagged wetlands
- Completed survey
 - Existing conditions
 - Pump station
- Borings
 - Geotechnical
 - Environmental/
contaminant soil testing



Glen Drive WTP – Concept to 10% Design

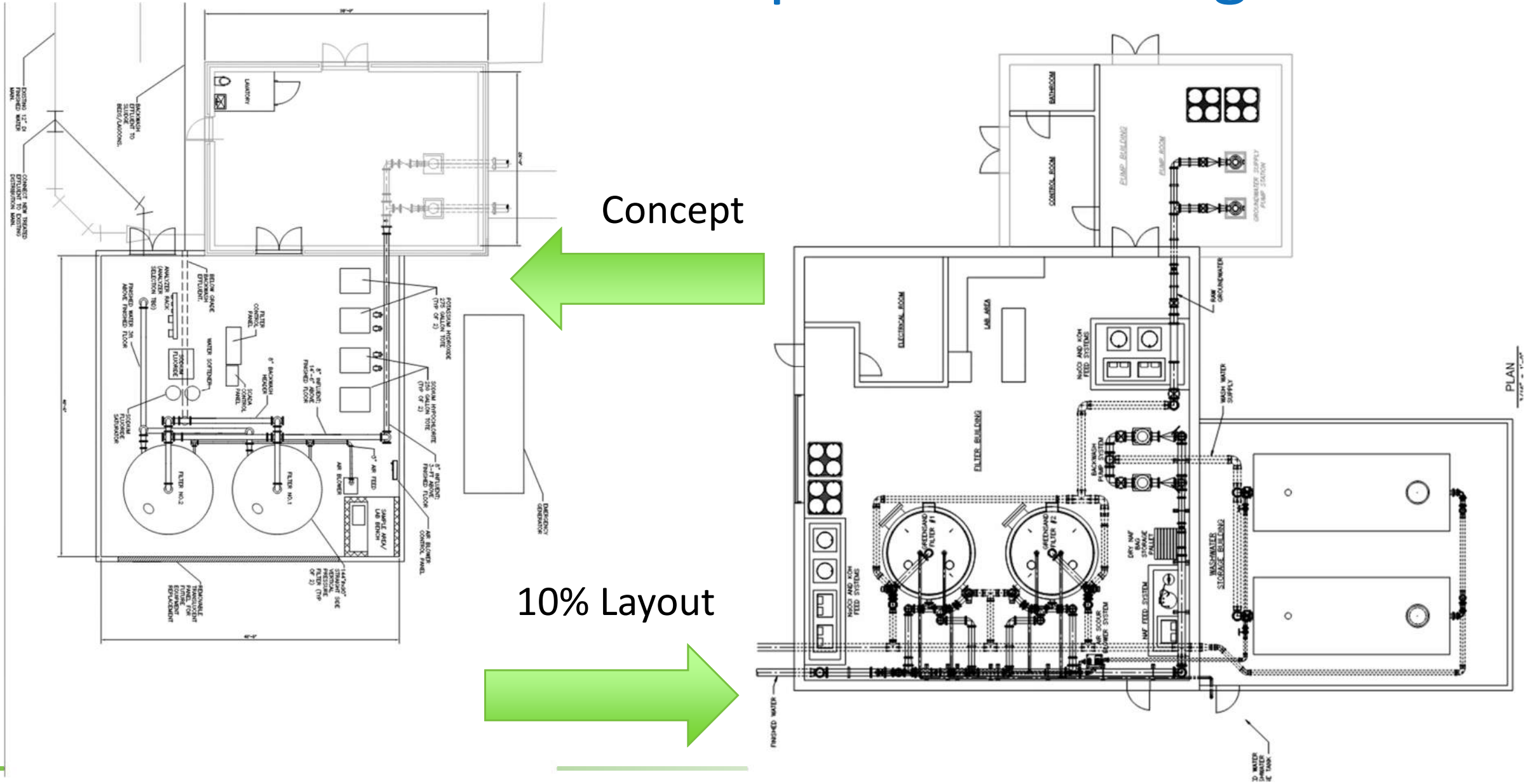

Glen Drive WTP – Concept to 10% Design

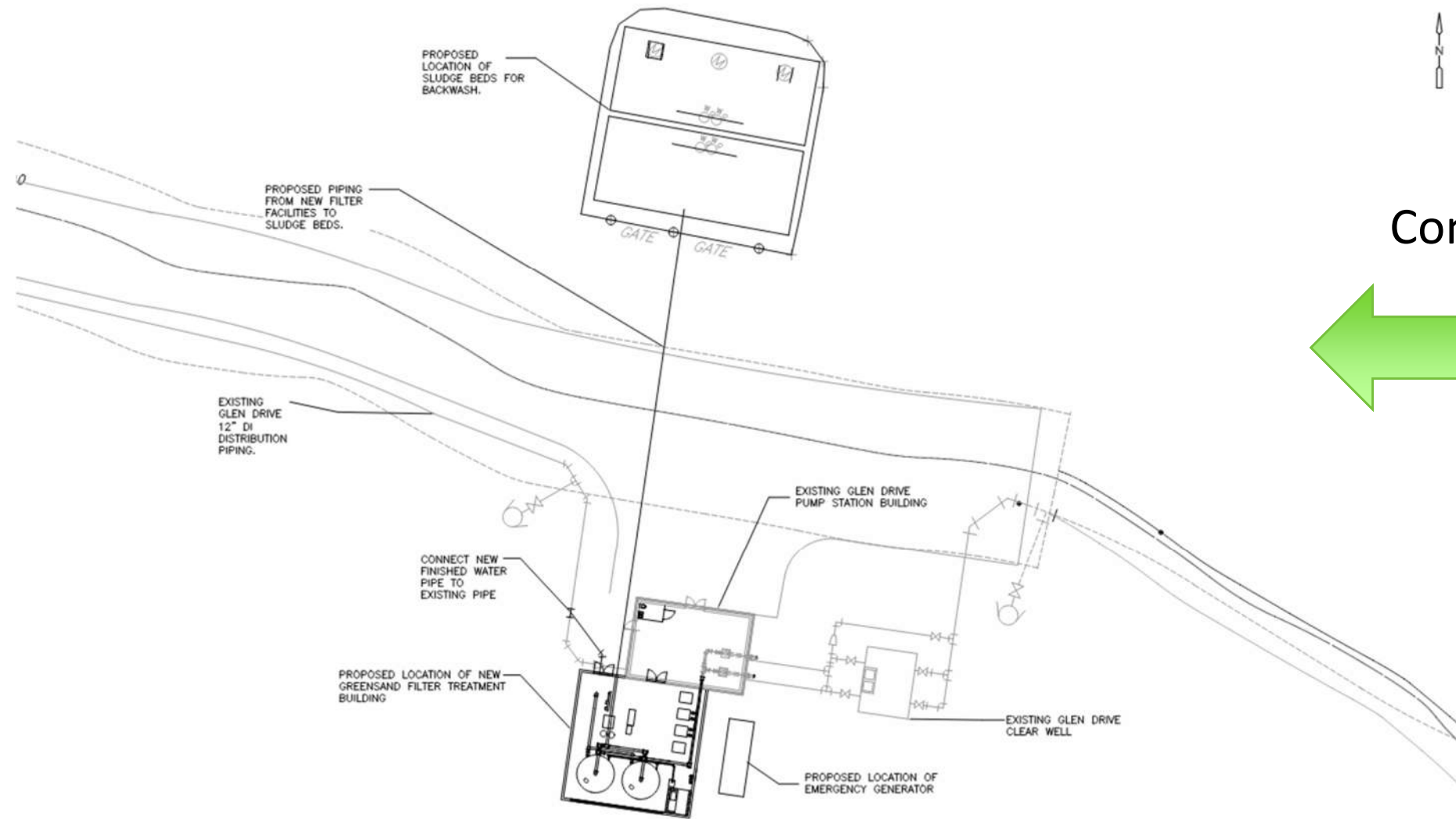

Concept

Glen Drive WTP – Concept to 10% Design

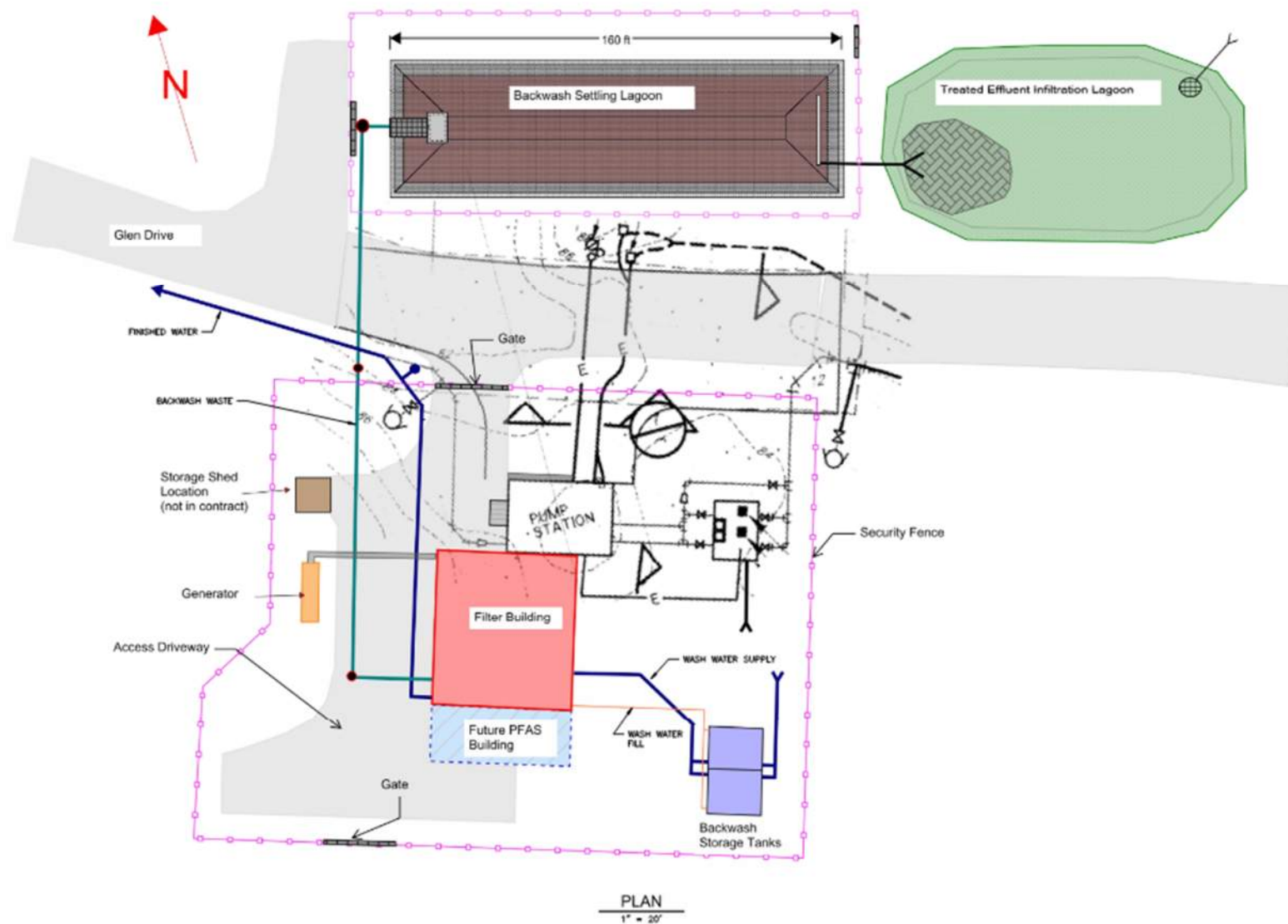

10% Design



Glen Drive WTP – 10% Design Model

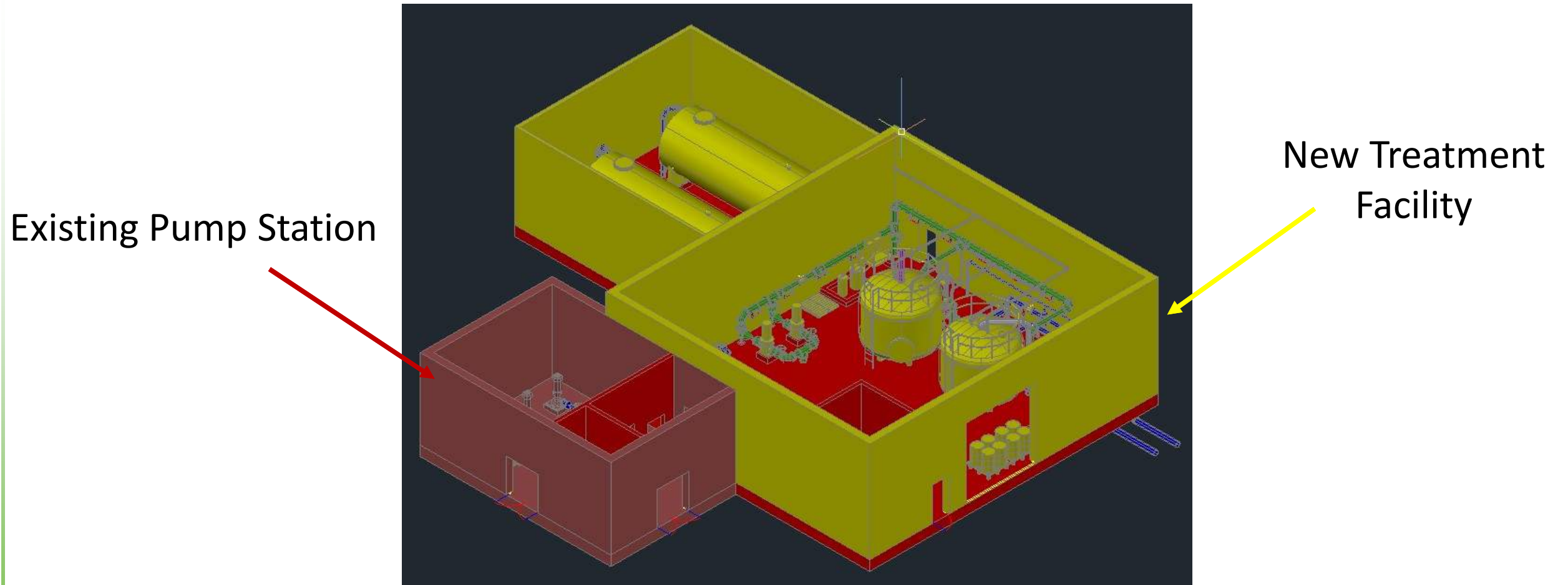

Glen Drive WTP – 10% Design Model

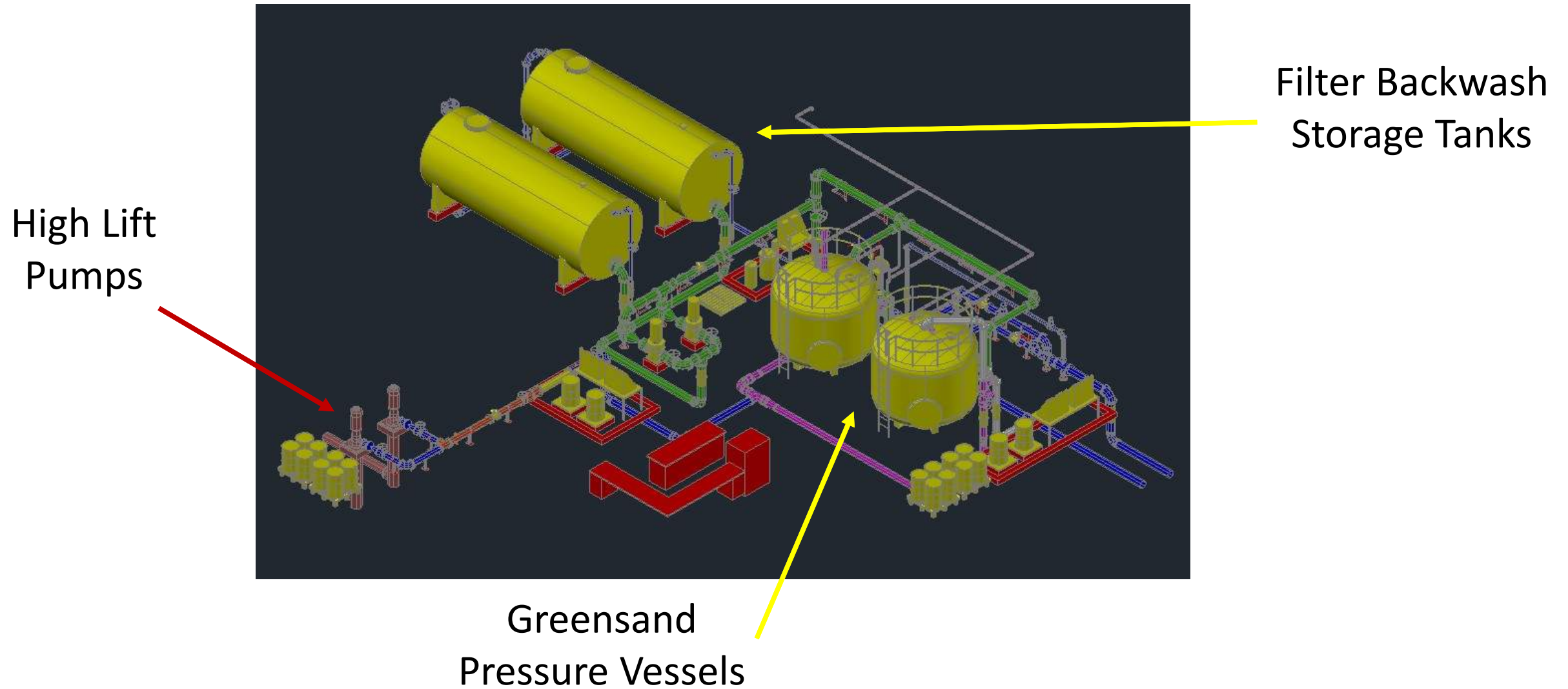

Glen Drive WTP – 10% Design Model

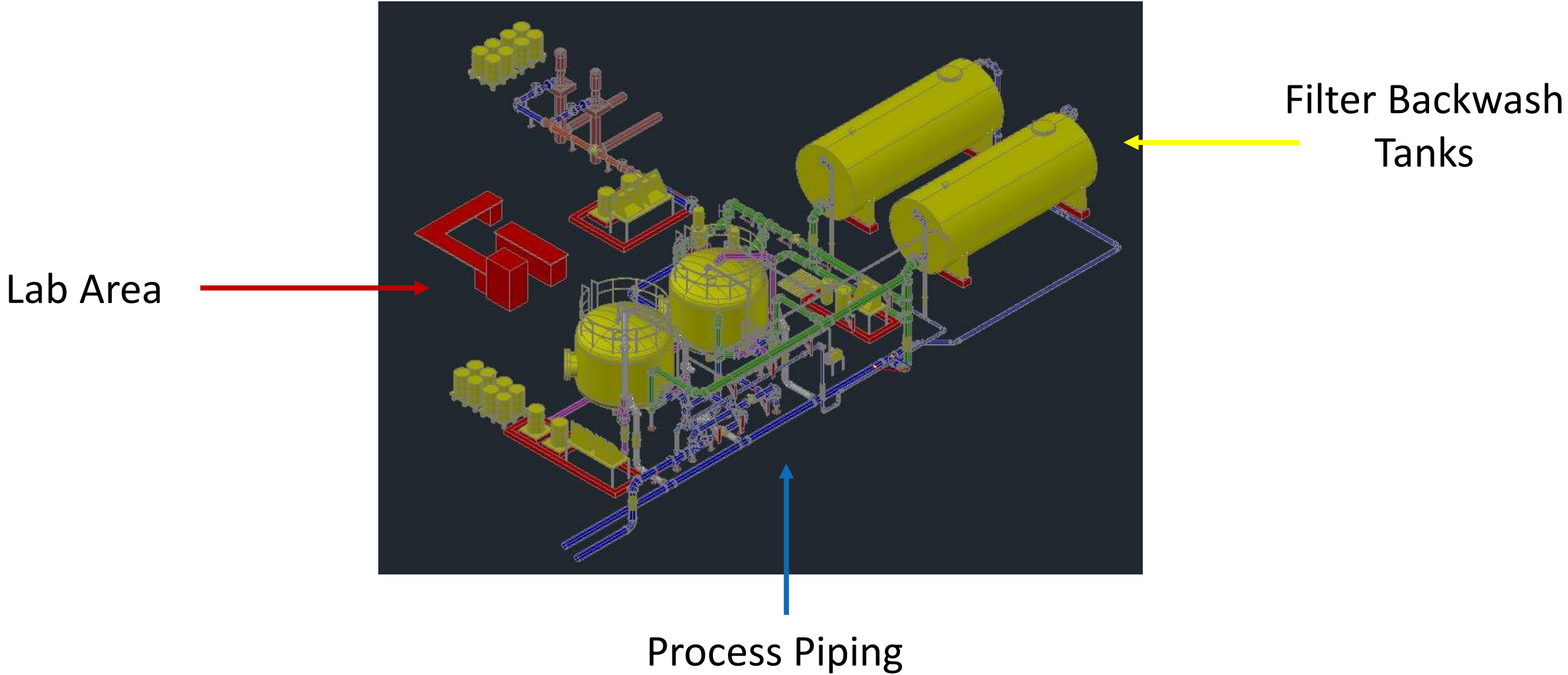

Glen Drive Water Treatment Plant Design

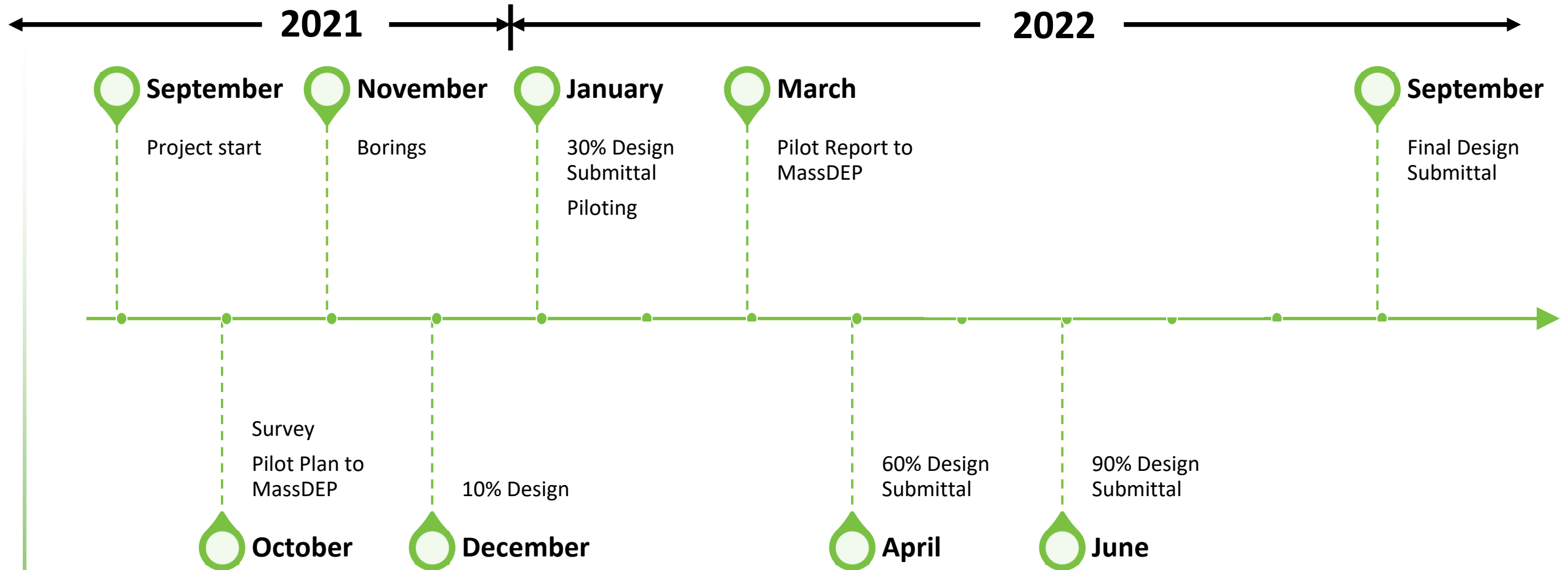

MWRA / Wakefield Interconnection

- Goal is to establish an additional water source for LCWD
- Project will construct a vault to meter & monitor water quality
- Vault will be located at Main Street & Bay State Road
- Lynnfield land, MassDOT right-of-way



Interconnection Project Status

Completed to Date:

- Survey received from Wakefield on November 17, 2021
- Soil borings conducted on November 24, 2021
- MassDOT permitting process started December 6, 2021

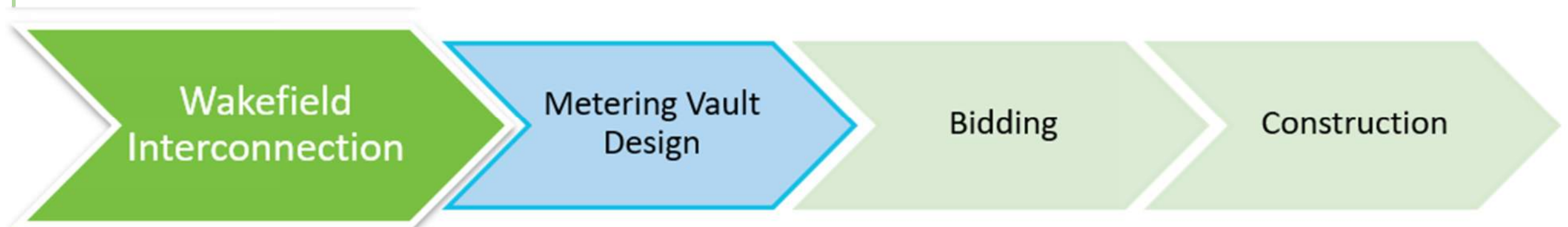

Interconnection Project Status

Next Steps:

- Develop bid documents for Spring 2022 bid
- Traffic calming and site access with Lynnfield
- Construction Summer / Fall 2022
- Complete ITA and MWRA process
- Parallel project: SCADA connection and upgrades

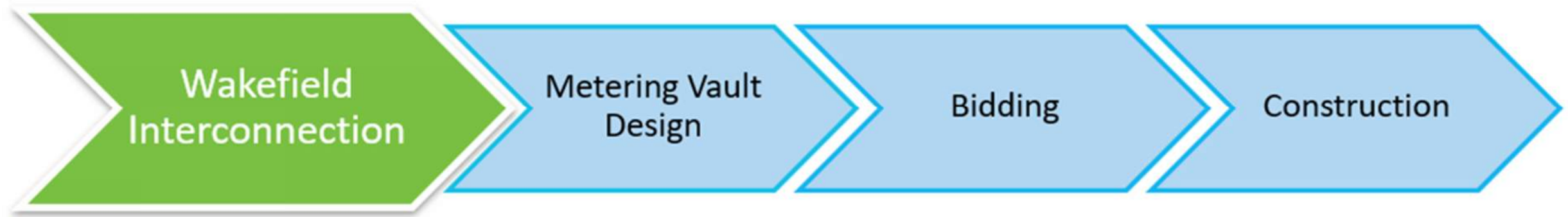

Interconnection Project Funding

LCWD is pursuing funding opportunities:

- American Rescue Plan Act (ARPA)
- Water Management Act (WMA) Grant
- Infrastructure Funding (pending)



Joining the MWRA

Phase 1 – Determine
the requirements with
WRC



- What is the process?
 - LCWD will be taking water from MWRA which withdraws from a different water basin
 - Requires review under the Interbasin Transfer Act (ITA), governed by Water Resources Commission (WRC) for applicability, insignificance and approval
 - Demonstrate acceptance of admission to MWRA by Board of Commissioners
 - Obtain approval of the Legislature and Governor
 - Submit application to the MWRA Advisory Board and Board of Directors community

MWRA Admission – Phase 1

- Completed to Date:
 - Notified MWRA of process moving forward
 - Initial outreach to WRC
 - Coordinating with WRC for meeting in January 2022
 - Compiling required documentation for admission process



MWRA Admission – Phase 1

- Next Steps:
 - Meet with WRC and MWRA
 - Define the requirements
 - Establish scope for Phase 2: Meet the Requirements



Capital Plan Recap

- All three projects underway
- By our next meeting:
 - Interconnection plans and specs
 - Defined scope of study from WRC
 - Glen Drive Facility 30% design milestone

Thank You

Questions